

**3824** Max. 7.5 W

AC/DC switch mode plug-in power supply

- Universal input voltage (90-264VAC)
- Compact design: 65x27x38 mm
- Fixed output voltages
- Short circuit proof
- Exchangeable DC plugs

For updates: see [www.mascot.no](http://www.mascot.no)

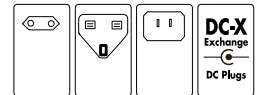

## TECHNICAL SPECIFICATIONS 12 V\*

### GENERAL INPUT/OUTPUT

Input voltage:	90-264 VAC, 47-63 Hz
Line frequency:	47 - 63 Hz
Load regulation:	< 8 %
Mains regulation:	< 0.5 %
Switch frequency approx.:	45 kHz
Overshoot: (90 - 10% load variation)	<300 mV
Undershoot: (10 - 90% load variation)	<300 mV
Temperature range	
• Operating:	-25 - +40°C
• With derating:	+ 60°C
• Storage:	-25 - +85°C
Derating:	200mW/°C over 40°C
Ripple:	< 200 mV p-p
Efficiency:	approx. 81 % at full load
Standby power:	≤ 0,075 W
Dimensions (L×W×H):	US+EU: 65 × 27 × 38 mm UK: 69 × 38 × 36 mm
Weight:	90g

### SAFETY PROTECTION EMC

Insulation class:	II
Insulation voltage	
Primary - secondary:	3000 VAC / 4200 VDC
Electrical safety std:	IEC 62368-1:2018
EMC standards	
• Emission:	EN 61000-6-3
• Immunity:	EN 61000-6-1
Input terminal:	Std. EU, UK, US
Output terminal:	Cord with/without plug, exch. plugs available

\* Some technical specifications may differ for other voltage versions.

## VERSIONS

Output (V) +/- 5%	Max. current (A)	Max. output power (W)
5	1.5A	7.5
12	0.65A	7.5

**US/EU**

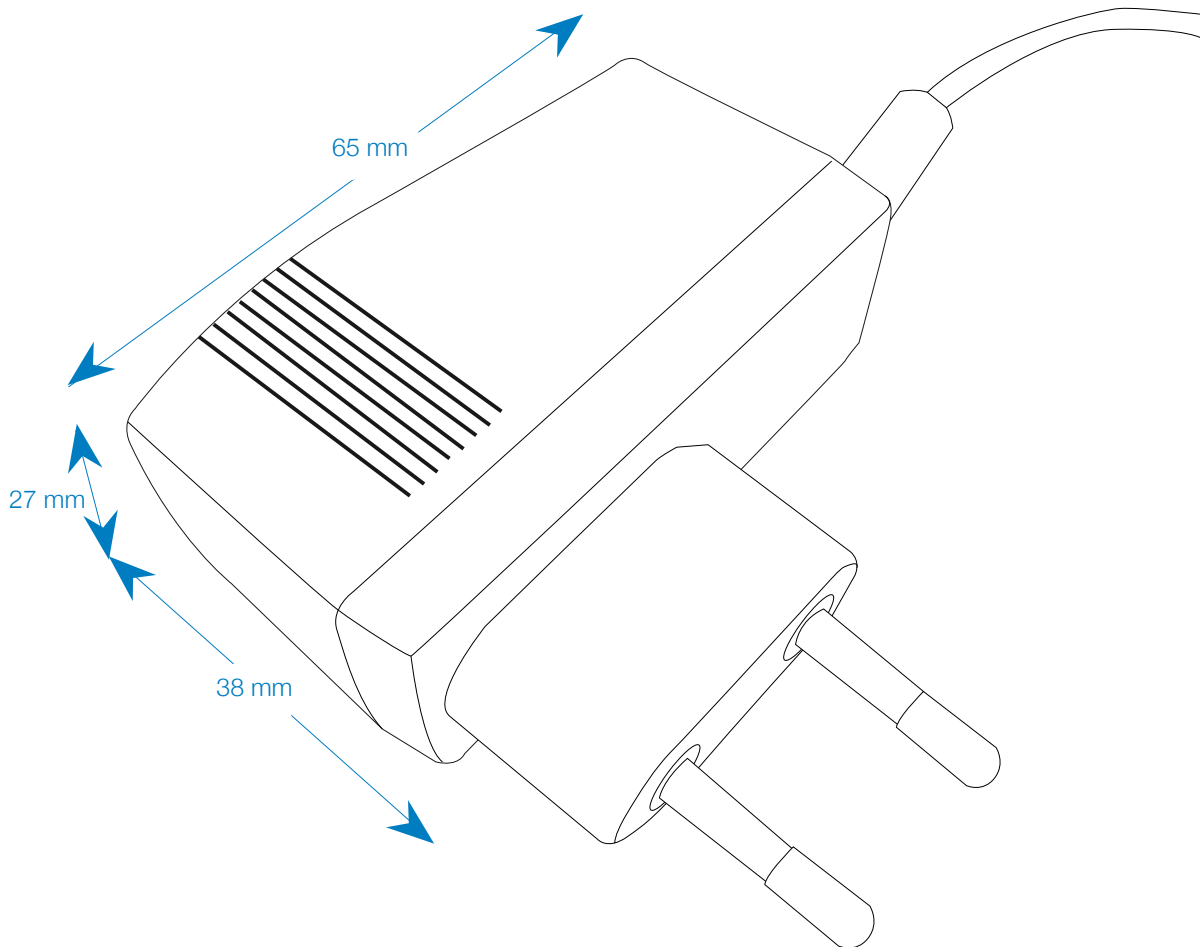

**UK**

